



Detex Corporation, 302 Detex Drive, New Braunfels, Texas 78130-3045
830-629-2900 / 800-729-3839 / Fax 800-653-3839 / Text photos only: 830-481-6433 / INTERNET: www.detex.com

INSTALLATION INSTRUCTIONS FOR 08D x 2W, 09D x 2W and 14D x 2W TRIM

drawing 105665: 08D x 2W
drawing 105666: 09D x 2W
drawing 105668: 14D x 2W

Table of Contents	Page
Device parts breakdown view.....	2
Device parts breakdown list with part numbers.....	3
Prep Trim, Prep Door.....	4
Install Trim.....	5
Rehanding.....	6

Should you have a Question/Problem with your Detex device please call Detex Technical Support from job site at 1-800-729-3839 and choose option 2 on our menu. Please do not return the product to the distributor.

**For WARRANTY information,
scan code below or
go to www.detex.com/warranty**

**For device installation videos,
scan code below or
go to www.detex.com/videos**

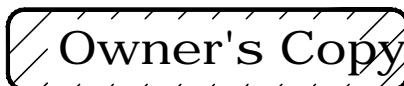

PARTS BREAKDOWN			
Item	P/N	QTY	Description
1	106264-7	1	LEVER ASSY, Q, 626
	106264-14		LEVER ASSY, Q, 693
	106264-15		LEVER ASSY, Q, 695
	101376-7		LEVER ASSY, S, 626
	101376-14		LEVER ASSY, S, 693
	101376-15		LEVER ASSY, S, 695
	101375-7		LEVER ASSY, U, 626
	101375-14		LEVER ASSY, U, 693
	101375-15		LEVER ASSY, U, 695
	101374-7		LEVER ASSY, T, 626
	101374-14		LEVER ASSY, T, 693
	101374-15		LEVER ASSY, T, 695
2	106603	2	WASHER, FLAT, 1"x0.02 THK (J LEVER ONLY)
	100851	1	WASHER, FLAT, 1"x0.06 THK (ALL EXCEPT J LEVER)
3	105664-9	1	ESCUTCHEON ASSY, 08Dx2W / 09Wx2W, BP2, 630 FINISH
	105669-9		ESCUTCHEON ASSY, 14Dx2W, BP2, 630 FINISH
4	100771	1	STOP, ROTATIONAL
6	104220	2	STANDOFF, HEX, BP2, EU
7	100775	1	WASHER, FLAT
8	103047	1	CLUTCH SPRING
9	103043	1	BOTTOM GEAR, WIDE
10	103044	1	TORQUE PLATE, WIDE
11	103994	1	KEY, SHEAR PIN, STEEL
12	100821	1	WASHER CLUTCH
13	100773	1	FLAT SPRING LOCKING (08D function only)
	101997		SPRING, COMPRESSION (09D function only)
14	102536-1	1	SCREW, 10-24, CUSTOM
15	100766	1	SPRING, RETURN
16	101509	1	SPRING, RETURN, HELPER
17	101436	1	RACK ASSEMBLY
18	100753	1	COVER PLATE
19	PP-5378-106	2	SCREW, MACH, 8-32 x 3/8 PPH
20	PP-5367-108	1	SCREW, MACH, 6-32 x 1/2 PPH
21	100762	1	TOP GEAR
22	101993	1	LOCK SLIDE (08D / 09D only)
23	104214	1	ADAPTER PLATE, BP2, EU
24	100572-9	1	CYLINDER COLLAR, SHORT
	100752-9		CYLINDER COLLAR, TALL
25	105964	1	WASHER, WAVE
26	103800-626	1	CYLINDER HOUSING, SFIC, MORTISE, 7 PIN, CHROME
	102281-7-X		CYLINDER, MORTISE, 5 PIN, CHROME
27	100754	1	PLATE, CYLINDER POSITION
28	100783	1	NUT, HEXAGON, CYLINDER
29	101478	1	SHAFT EXTENSION ASSEMBLY
30	104224-14	1	LOCKNUT, 1/4-20, NYLON INSERT
31	102264-2	2	SCREW, 1/4-20 x 3/8 PFH, UNDERCUT

Your particular part or configuration may not be shown:
Contact Detex technical support at 800-729-3839 (option 2)

Tools Required:

- Safety Glasses**
- Power Drill**
- Tape Measure**
- Level**
- Pencil**
- Center Punch**
- Hammer**
- #2 and #3 Phillips Screw Drivers**
- Drill bits:**
 - 5/16"**
 - 1/2"**
 - 3/4"**

FOR ITEM 26
"-X" REFERS TO
KEY CODE
AA-KK



STEP 1: PREP TRIM

Install tailpiece & cylinder (14 function requires no cylinder)

- NOTE: 1. Mortise cylinder NOT supplied with trim, but can be ordered separately.
 2. Trim handing is field reversible.
 3. 6-pin cylinder installation shown.

Follow steps A through C in order:

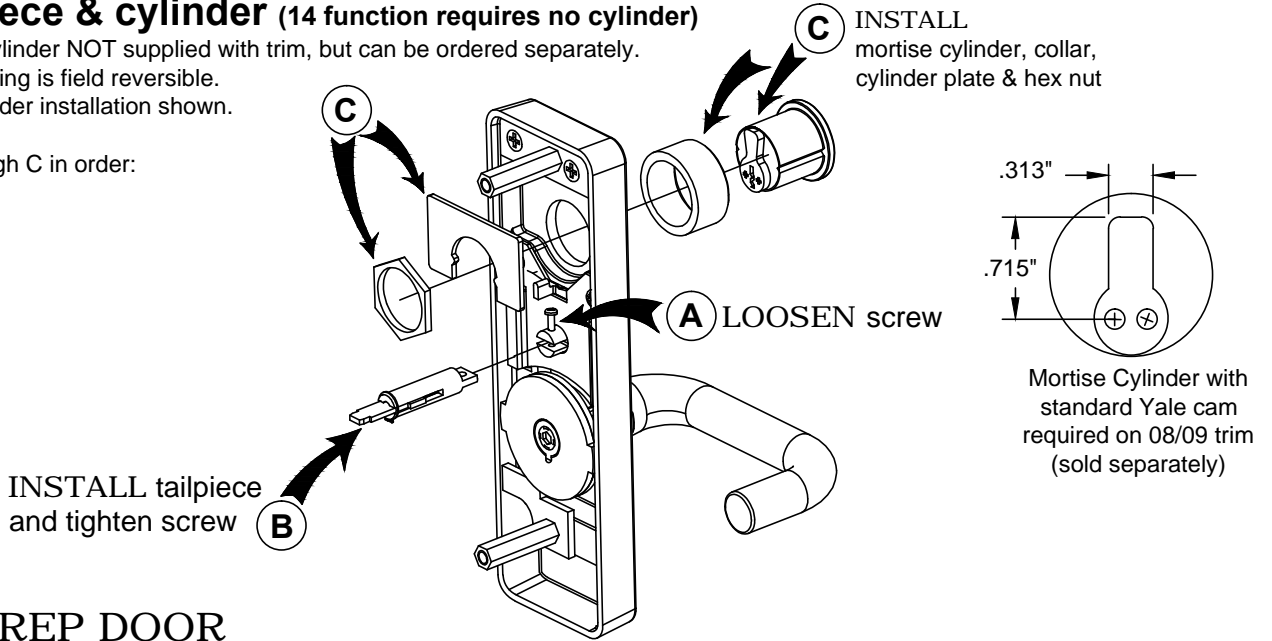

STEP 2: PREP DOOR

Mark and drill holes. (LHR installation shown, reverse for RHR)

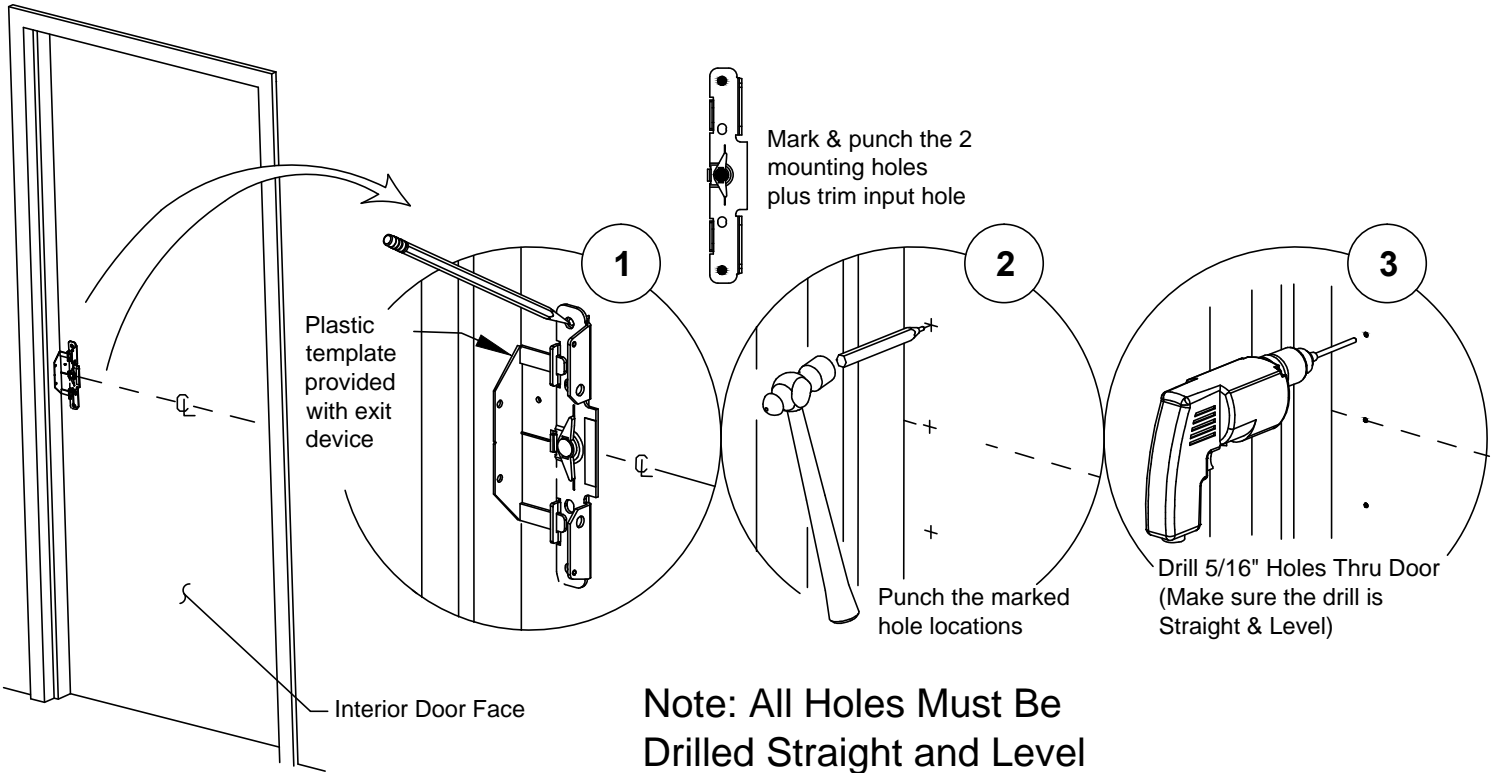



DEVICE SIDE
 Enlarge center pilot hole to 3/4"

TRIM SIDE
 Enlarge center pilot hole to 3/4" and the other 2 holes to 1/2"

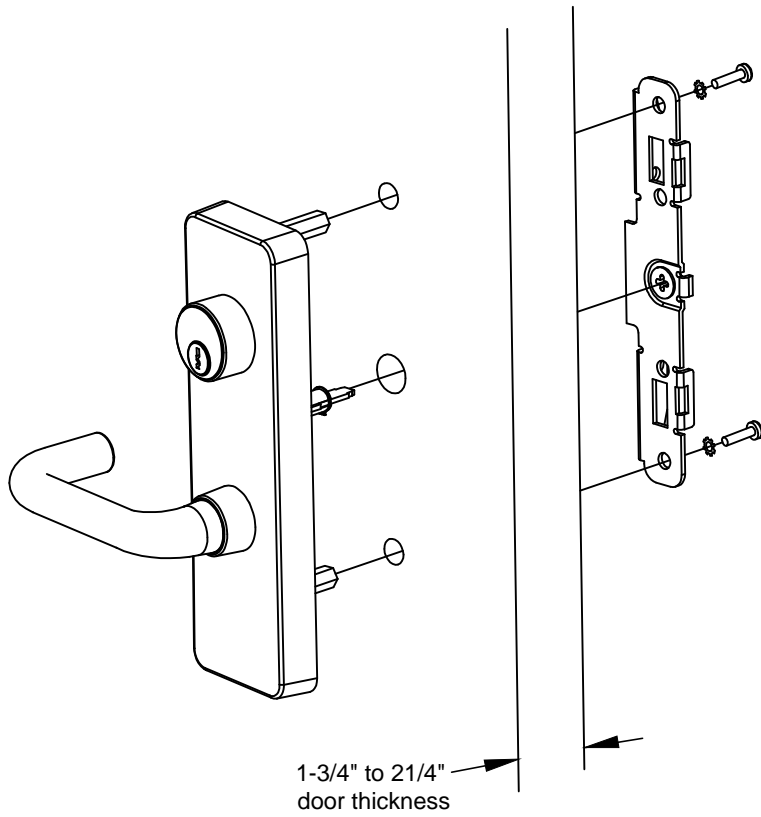
STEP 3: INSTALL TRIM



Hardware supplied with exit device
 1/4-20 x 1" Machine screw
 #1/4 Lock washer

TRIM INSTALLATION COMPLETE
Continue installation using device instructions

CHANGE LEVER HANDING

- A. Remove tailpiece extension assembly screw. (Remove tailpiece extension assembly if necessary).
- B. Remove lower stand-off and stop plate.
- C. **WARNING: Springs under pressure!** Remove spring retaining plate. Carefully remove the springs.
- D. Switch lock spring to opposite side (for 09 function only).
- E. Remove top gear.
- F. Loosen the clutch center screw approximately two (2) turns. Bend locking tab back to disengage with notch.
- G. Slide the locking bar away from the rack (not necessary for 14 function). Remove the rack while rotating the lever.
- H. Continue rotating the lever to the opposite side.
- I. Rotate the lever to the position shown. Partially engage the rack and the clutch gear on the opposite side.
- J. Rotate the lever until the rack is completely seated.
- K. Insert the top gear.
- L. Add permanent thread locking adhesive and tighten the clutch center screw. Bend tab over screw notch so that screw cannot turn.
- M. **Warning: Springs under pressure!** Install the springs. Hold the lever in the down position, firmly compressing the springs in place.
- N. While holding the lever in the down position, replace the spring retaining plate and fasten the two (2) screws.
- O. Reverse the stop plate and fasten the stand-off.
- P. Replace tailpiece extension assembly (if removed) and assembly screw.

Handing is complete.

