

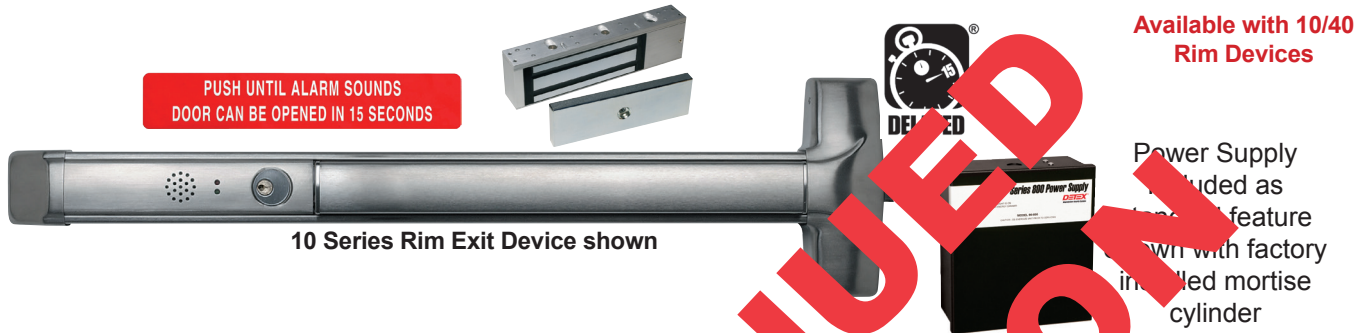

Delayed Egress with Magnetic Locking (EM)

The Delayed Egress Magnetic Locking (EM) option provides a secure 2-point locking device with 15-second delay and a 100dB alarm when someone attempts to exit. This 15-second delay allows time for management to respond to the alarm before someone exits and the alarm deters the exit from occurring. Per life safety requirements, the EM must be provided with a fire alarm input, thus providing a system override during a fire emergency. The EM provides security while meeting all life safety concerns, offering an exceptional value.



10 Series Rim Exit Device shown

Benefits

- Fast and easy installation
- Durable design provides years of trouble-free protection
- Controls foot traffic, deters unauthorized exits, prevents loss and meets code requirements
- 2-point locking provides tandem-holding force of latch bolt (1400 lb) and electromagnetic lock (1500 lb)
- Reduces employee and customer downtime
- Fits almost any door in any décor
- One cylinder provides arming, disarming and dogging

Features

- Powered by a 24VDC filtered and regulated power supply
- Heavy-duty angled end-cap
- 9V battery provides alarm function only in case of power failure
- Panic Device and power supply have passed testing for electrostatic discharge (ESD) by independent testing laboratories
- Heavy-duty anodized aluminum rail extrusion
- Armed and disarmed field selectable status indicator
- Power supply delivers a constant 24VDC of power and regulated voltage under a rated load of 1A, including surge protection and transient noise suppression circuitry
- Accommodates all types of mortise cylinders with a standard Yale cam
- Delayed arming allows arming after door closes
- Patented mounting plate and strike locator system provide perfect alignment with door and frame
- Remote signal output and remote bypass input standard
- Single mortise cylinder provides arming and dogging - can be factory installed
- Alarm triggered by latch bolt or pushpad movement
- Stainless steel, 3/4" diameter locking Pullman-type latch bolt
- State-of-the-art electronics offer reliable security and instantaneous alarm
- Fire alarm input can be connected at power supply or panic bar
- Non-handed, field sizeable
- Visual and audible arming indicators
- 100dB alarm
- Includes delayed egress panic bar, 24VDC filtered and regulated power supply, 1500 lb electromagnetic lock and door sign
- 1/8 turn cylinder dogging

Mechanical Options

- MC65 - Factory Installed Mortise cylinder
- CD - Cylinder Dogging (Std.)
- 99 - Surface Strike (Std.)
- IC7 - Factory Installed IC Housing
- LD - Less Dogging
- 98 - Semi Mortise Strike
- FC - Flex Conduit and End Cap
- KS - Key Stop (Key removed only when armed)
- F - 3-Hour Fire Rated
- 36" Door Width (Std.)
- H - Hurricane Rated
- 48" Door Width



Electrical Options

- 30 Second Delayed Egress (must have letter from AHJ)
- AL18 - Surface Armored Loop (Door/Frame mounted)
- PT5 - Power Transfer

Accessories

- SN1 - Sex Nut fasteners
- Outside trim options (See Advantex Trim Options)
- Foreign Language Signs available Contact Factory

Technical Information

- Door Types - Wood, Hollow Metal, Fiberglass or Aluminum
- Door Stile - See applicable device page
- Machine and Self-Drilling Screws (Std.)
- Door Thickness - Fits standard 1 3/4" - 2 1/4"
- Optional Sex Nuts or Security Torx Screws available

Device Finishes

605 / US3	Polished Brass	628 / US28	Aluminum	693 / US27	Black, Painted
606 / US4	Brushed Brass	629 / US32	Polished Stainless Steel	695 / US31	Dark Bronze, Painted
611 / US9	Polished Bronze				
612 / US10	Brushed Bronze	630 / US32D	Brushed Stainless Steel		
613 / US10B	Oil Rubbed Bronze				

Riser Diagram



Terminal Block

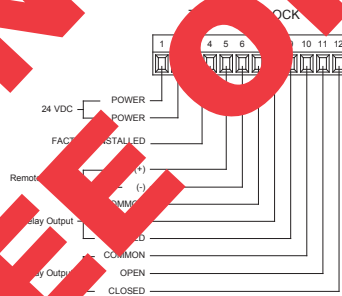

Listings and Approvals

See individual device (i.e. 10 Series) catalog page for listings and approvals

Detex Limited Warranty

10 Year Mechanical/3 Year Electrical Limited Manufacturer's Warranty

Cancer & Reproductive Harm - www.detex.com/prop65

Where Trust is Built™
DETEX®
Life Safety and Security Door Hardware

Detex Corporation
 302 Detex Drive
 New Braunfels, Texas 78130-3045 USA
 PH. (830) 629-2900
 (800) 729-3839
 FAX (800) 653-3839
<http://www.detex.com>
 USA Sales:
marketing@detex.com
 International Sales:
export@detex.com