

Detex Corporation, 302 Detex Drive, New Braunfels, Texas 78130-3045  
(830)629-2900 / 1-800-729-3839 / Fax (830)620-6711  
E-MAIL: detex@detex.com INTERNET: www.detex.com

## INSTALLATION INSTRUCTIONS FOR 02Z & 03Z ANTI-VANDAL TRIM

02Z ANTI-VANDAL TRIM P/N: 105640  
03Z ANTI-VANDAL TRIM P/N: 105650

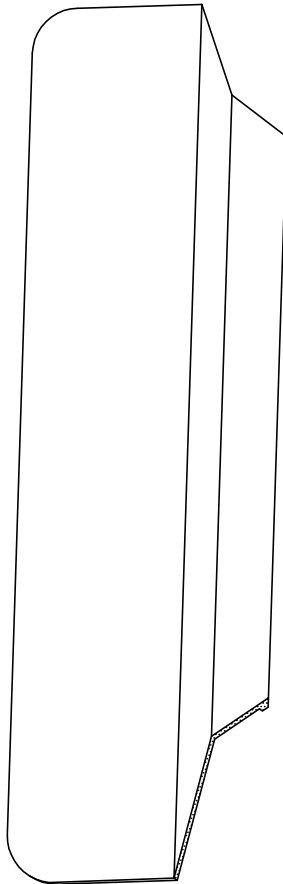



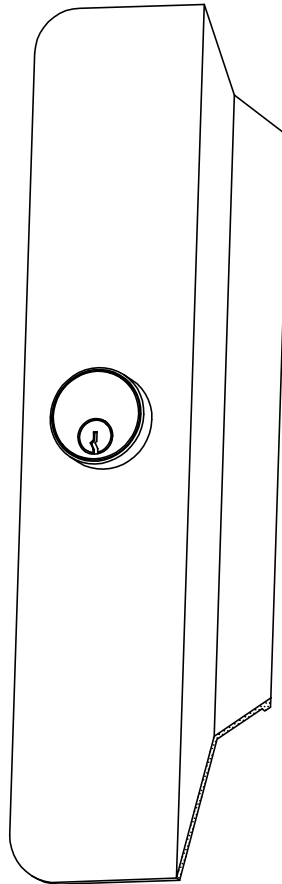

**02Z**  
**FUNCTION**



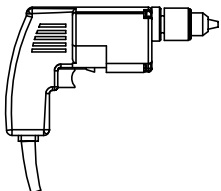

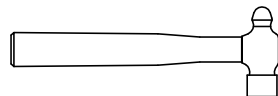
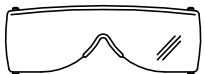
**03Z**  
**FUNCTION**

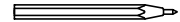
## Tools Required

Power Drill 	Pencil 		
	Hammer 		
Safety Glasses 	Screw Driver 	Tape Measure 	Center Punch 

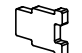
## 03Z Trim Preparation (No prep necessary for 02Z trims)

Tailpiece Used	Door Thickness
	1-3/4" and 2" Thick Doors
	2-1/4" Thick Doors

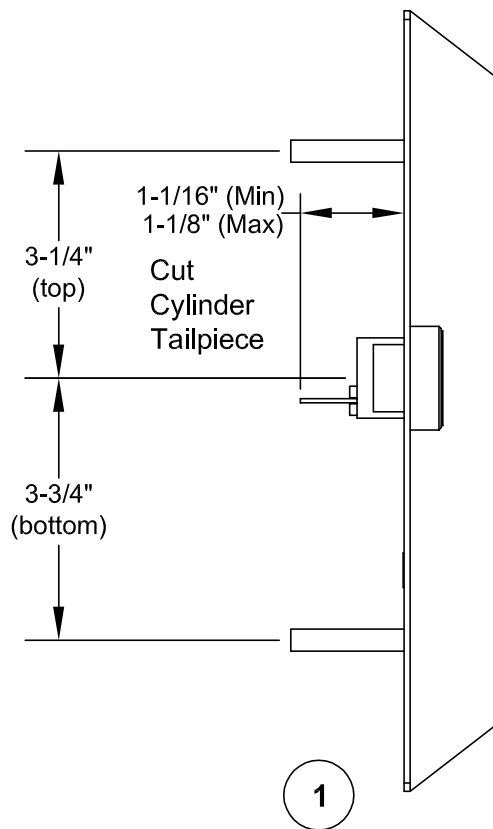

**Rim Cylinder  
Preparation**

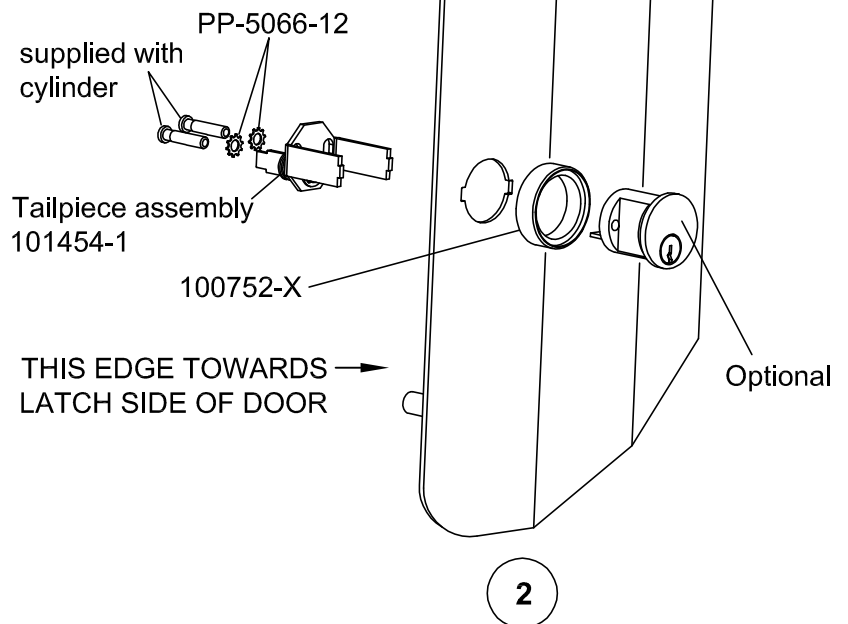

**Install  
Tailpiece Assembly**

# Door Preparation

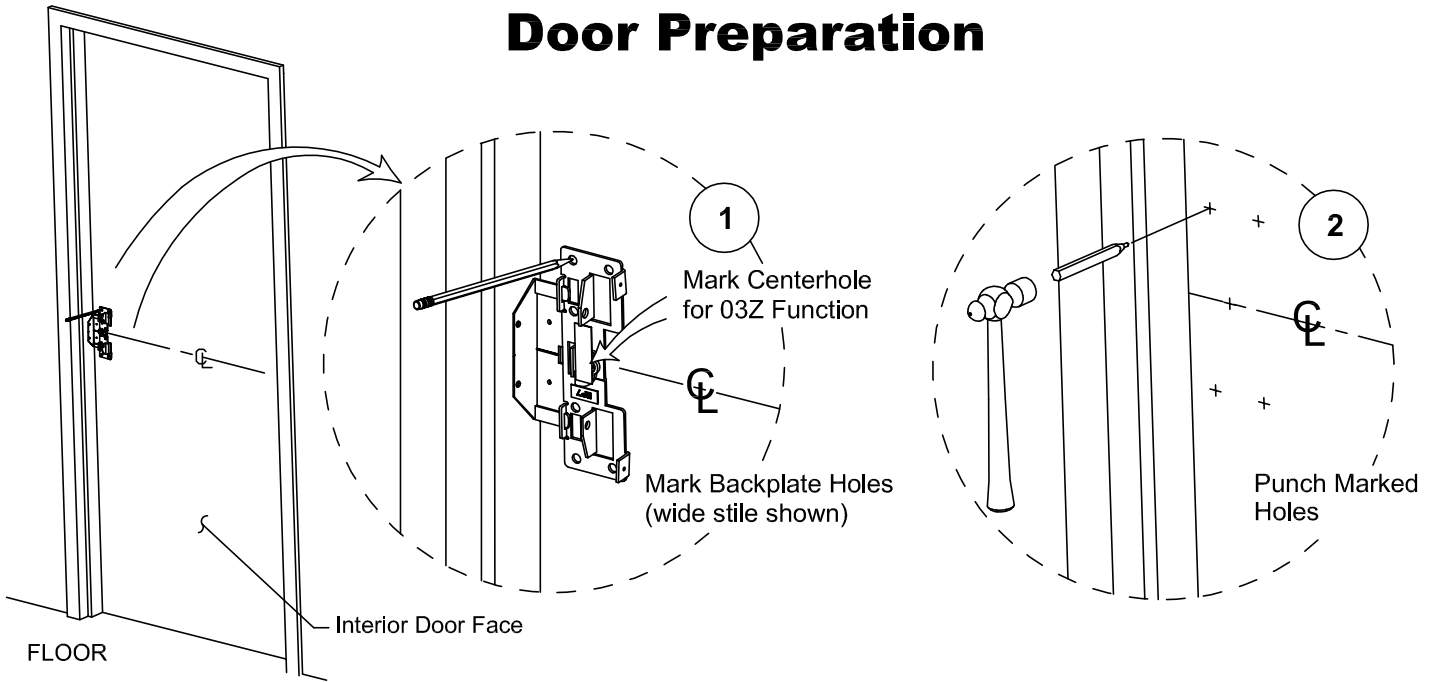

**Note: All Holes Must Be Drilled Straight and Level**

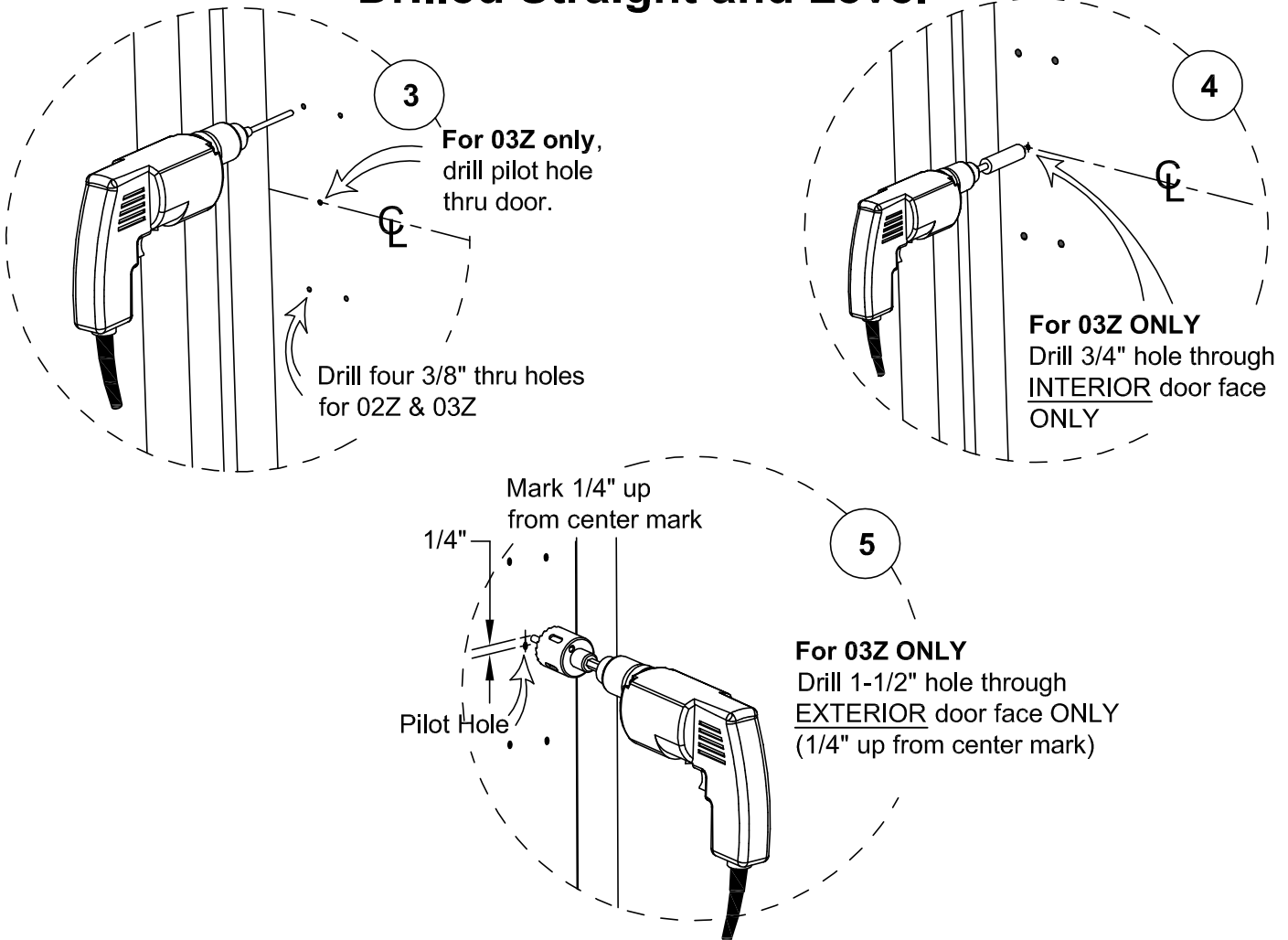

# Installing Trim (03Z shown)

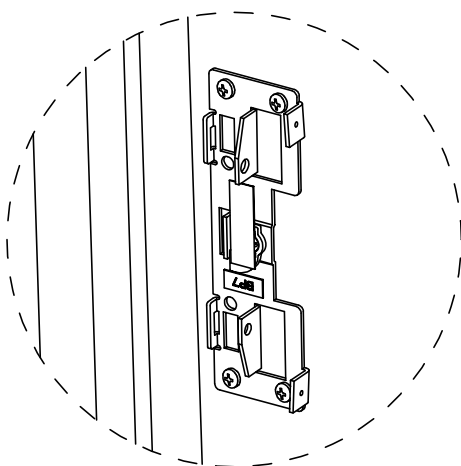
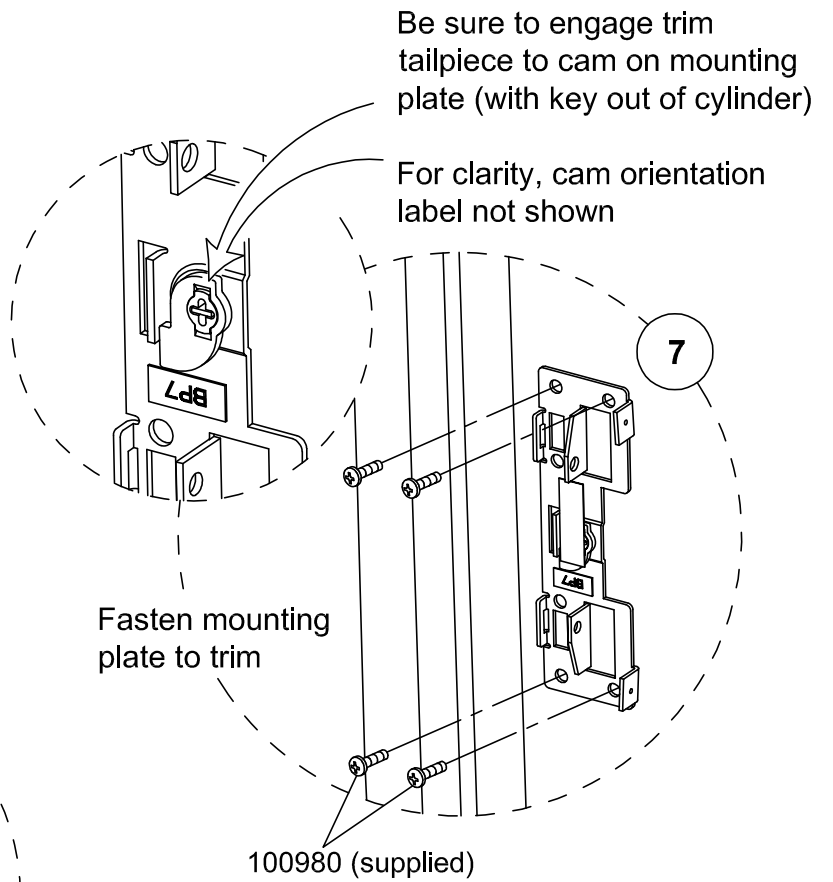
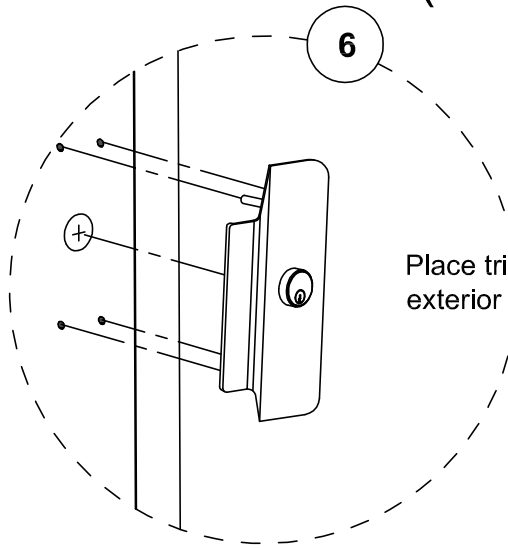

Continue with Exit  
Hardware Instructions