

REINFORCEMENT FOR STRIKE
AS REQUIRED, 2 PLACES

RECOMMENDED CUTOUT

#12-24 TAPPED HOLES
2 PLACES

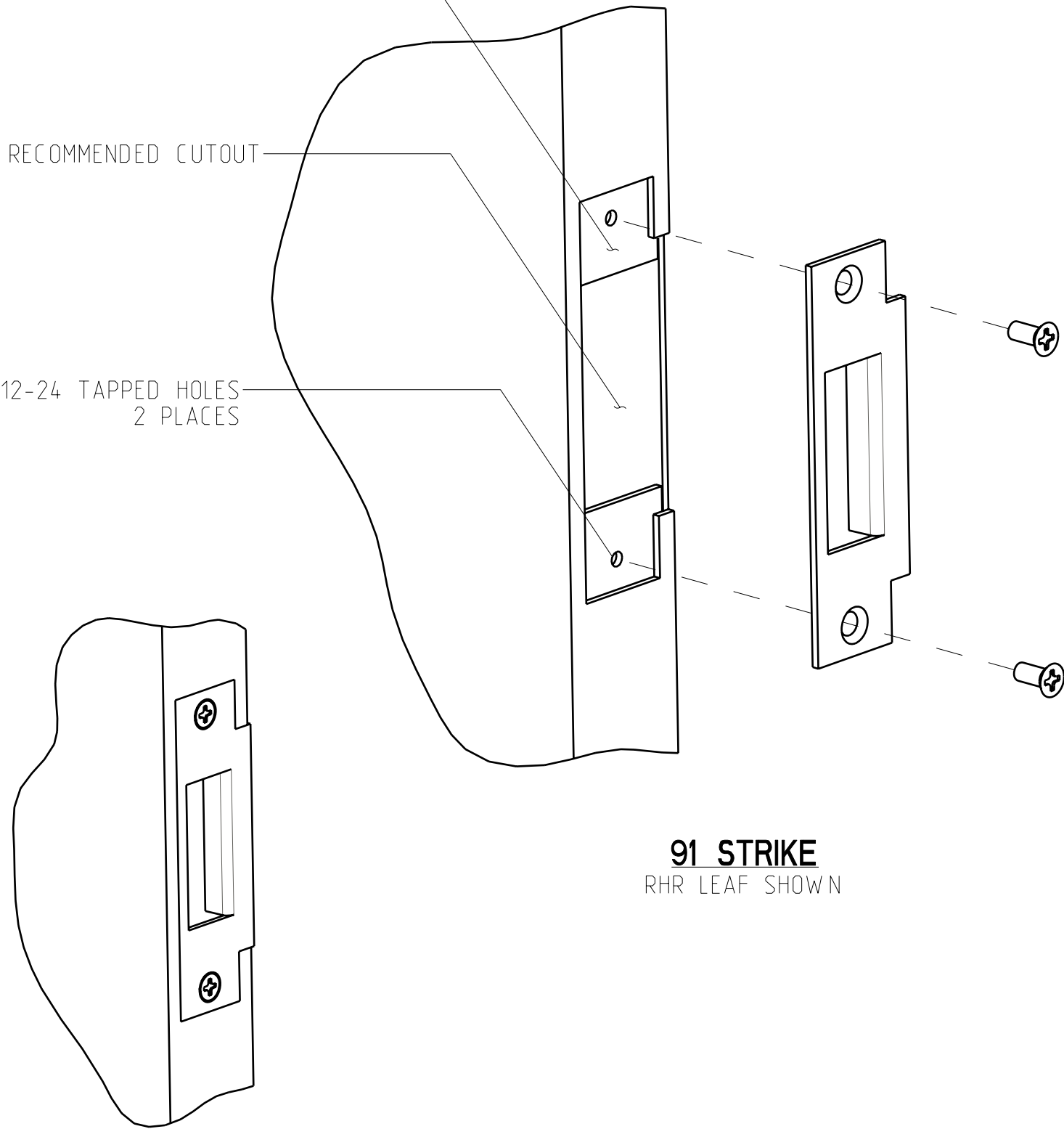

91 STRIKE
RHR LEAF SHOWN

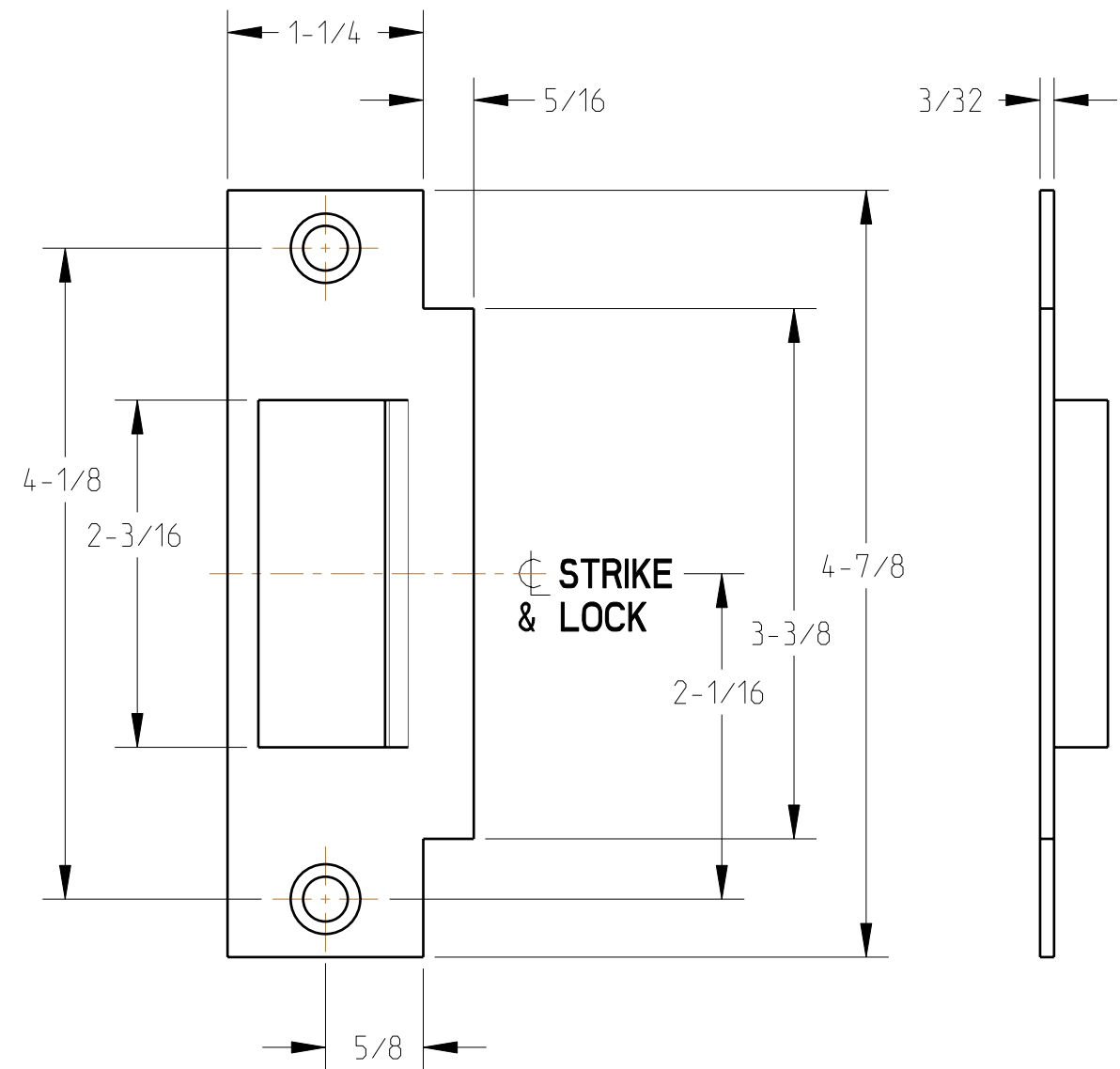

RESPONSIBILITY
Door and Frame Manufacturers are responsible for providing adequate construction or reinforcements for proper installation of hardware shown. All architectural builders hardware must be installed on properly reinforced doors and frames regardless of the type, material, or method of construction.

91 STRIKE
(DOUBLE DOOR WITH OVERLAPPING ASTRAGAL, ANSI, FLAT LIP)
FOR MORTISE LOCK

DETEX[®]
CORPORATION

SCALE: 1:1

DATE: 8/29/06

TEMPLATE NO: T2003