



Detex Corporation, 302 Detex Drive, New Braunfels, Texas 78130-3045
830-629-2900 / 800-729-3839 / Fax 800-653-3839 / Text photos only: 830-481-6433 / INTERNET: www.detex.com

INSTALLATION INSTRUCTIONS FOR "10 FUNCTION" LEVER TRIM (10 and 30 series)

Drawing: 103310

Table of Contents

	Page
Device parts breakdown view.....	2
Device parts breakdown list with part numbers.....	3-4
Prep Trim.....	5
Prep Door (Rim).....	6
Prep Door (Mortise).....	7
Install Trim, Cut Rim Key Cylinder Tailpiece, Install Rim Cylinder to Bracket.....	8
Install Assembly to Device Backplate.....	9
Install Cover.....	10

For **WARRANTY** information,
scan code below or
go to www.detex.com/warranty



For device installation videos,
scan code below or
go to www.detex.com/videos



Owner's Copy

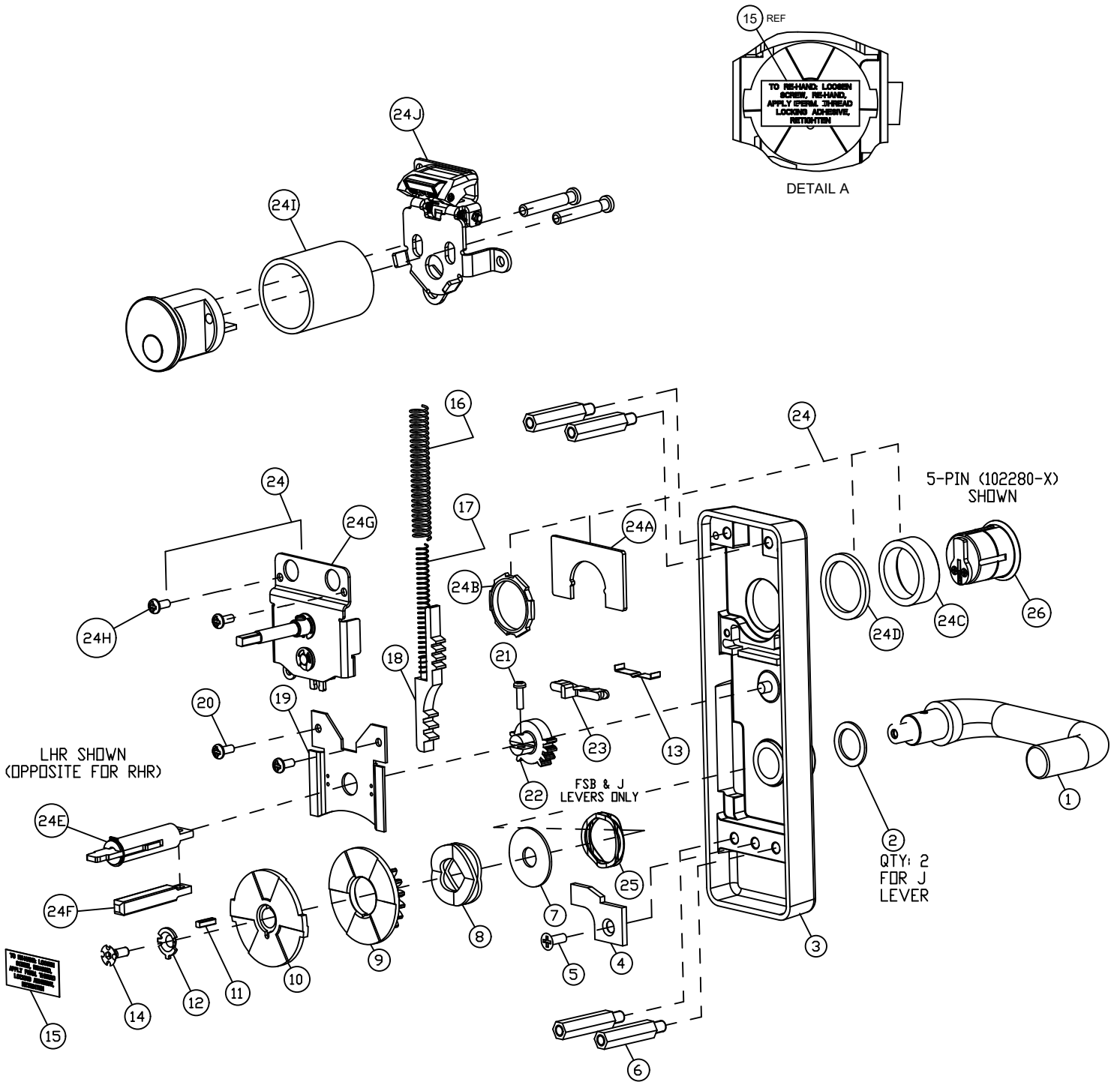

PARTS BREAKDOWN			
Item	Order Part #	QTY	Description
1	106494-8	1	LEVER ASSY, J, LHR, 629
	106494-9		LEVER ASSY, J, LHR, 630
	106495-8		LEVER ASSY, J, RHR, 629
	106495-9		LEVER ASSY, J, RHR, 630
	105965-1016		LEVER ASSY, FSB, 1016, 630
	105965-1035		LEVER ASSY, FSB, 1035, 630
	105965-1058		LEVER ASSY, FSB, 1058, 630
	105965-1075		LEVER ASSY, FSB, 1075, 630
	105965-1076		LEVER ASSY, FSB, 1076, 630
	105965-1093		LEVER ASSY, FSB, 1093, 630
	105965-1108		LEVER ASSY, FSB, 1108, 630
	105965-1119-1		LEVER ASSY, FSB, 1119, RHR, 630
	105965-1119-2		LEVER ASSY, FSB, 1119, LHR, 630
	105965-1147		LEVER ASSY, FSB, 1147, 630
	106264-7		LEVER ASSY, Q, 626
	106264-14		LEVER ASSY, Q, 693
	106264-15		LEVER ASSY, Q, 695
	101376-7		LEVER ASSY, S, 626
	101376-14		LEVER ASSY, S, 693
	101376-15		LEVER ASSY, S, 695
	101375-7		LEVER ASSY, U, 626
	101375-14		LEVER ASSY, U, 693
	101375-15		LEVER ASSY, U, 695
	101374-7		LEVER ASSY, T, 626
101374-14	LEVER ASSY, T, 693		
101374-15	LEVER ASSY, T, 695		
2	106603	2	WASHER, FLAT, 1"x0.02 THK (J LEVER ONLY)
	100851	1	WASHER, FLAT, 1"x0.06 THK (ALL EXCEPT J LEVER)
3	103344-7	1	EXCUTCHEON ASY 10D BP1 10 FUNC IND, 626
	103344-9		EXCUTCHEON ASY 10D BP1 10 FUNC IND, 630
	103344-14		EXCUTCHEON ASY 10D BP1 10 FUNC IND, 693
	103344-15		EXCUTCHEON ASY 10D BP1 10 FUNC IND, 695
4	100771	1	STOP, ROTATIONAL
5	PP-5305-108	1	SCREW, MACH, 10-24 X 1/2 PFH
6	100777	4	STANDOFF, HEX
7	100775	1	WASHER, FLAT
8	103047	1	CLUTCH SPRING
9	103043	1	BOTTOM GEAR, WIDE
10	103044	1	TORQUE PLATE, WIDE
11	103994	1	KEY, SHEAR PIN, STEEL
12	100821	1	WASHER CLUTCH
13	100773	1	FLAT SPRING LOCKING
14	102536-1	1	SCREW, 10-24, CUSTOM
15	103029	1	LABEL, REHANDING
16	100766	1	SPRING, RETURN
17	101509	1	SPRING, RETURN, HELPER

Your particular part or configuration may not be shown:
Contact Detex technical support at 800-729-3839 (option 2)

PARTS BREAKDOWN CONTINUED			
Item	Order Part #	QTY	Description
18	101436	1	RACK ASSEMBLY
19	100753	1	COVER PLATE
20	PP-5378-106	2	SCREW, MACH, 8-32 x 3/8 PPH
21	PP-5367-108	1	SCREW, MACH, 6-32 x 1/2 PPH
22	100762	1	TOP GEAR
23	101993	1	LOCK SLIDE
24KIT	107112-5	1	HARDWARE KIT 10D TRIM 10 FUNC LHR, 613, RIM
	107112-7		HARDWARE KIT 10D TRIM 10 FUNC LHR, 626, RIM
	107112-12		HARDWARE KIT 10D TRIM 10 FUNC LHR, 613, MORTISE
	107112-14		HARDWARE KIT 10D TRIM 10 FUNC LHR, 626, MORTISE
	107113-5		HARDWARE KIT 10D TRIM 10 FUNC RHR, 613, RIM
	107113-7		HARDWARE KIT 10D TRIM 10 FUNC RHR, 626, RIM
	107113-12		HARDWARE KIT 10D TRIM 10 FUNC RHR, 613, MORTISE
	107113-14		HARDWARE KIT 10D TRIM 10 FUNC RHR, 626, MORTISE
24A	100754	1	PLATE, CYLINDER POSITION
24B	100783	1	NUT, HEXAGON, CYLINDER
24C	103332-7	1	CYLINDER COLLAR, 5-PIN, CHROME 626
24D	103346-7	3	CYLINDER COLLAR, 1/8, CHROME 626
24E	101478	1	SHAFT EXTENSION ASSEMBLY
24F	103218	1	SHAFT, INPUT (MORTISE)
24G	107110-1	1	TRIM GEAR ASY 10-FUNCTION
24H	PP-5378-106	2	SCREW, MACH, 8-32 x 3/8 PPH
24I	NO SALE	1	COLLAR, CYLINDER
24J	107114-1	1	CYL BRKT ASY, 10-FUNCTION IND LHR
	107115-1		CYL BRKT ASY, 10-FUNCTION IND RHR
25	NO SALE	1	WASHER, WAVE
26	103800-612	1	CYLINDER HOUSING, MORTISE, 7 PIN, BRONZE
	103800-613		CYLINDER HOUSING, MORTISE, 7 PIN, OIL RUB BRONZE
	103800-626		CYLINDER HOUSING, MORTISE, 7 PIN, CHROME
	102281-4-X		CYLINDER, MORTISE, 5 PIN, BRONZE
	102281-5-X		CYLINDER, MORTISE, 5 PIN, OIL RUB BRONZE
	102281-7-X		CYLINDER, MORTISE, 5 PIN, CHROME

FOR ITEM 26
"-X" REFERS TO
KEY CODE
AA THRU KK



Your particular part or configuration may not be shown:
Contact Detex technical support at 800-729-3839 (option 2)

STEP 1: PREP TRIM

NOTE:

1. Mortise cylinder NOT supplied with trim, but can be ordered separately.
2. Trim handing is field reversible. Device cover is handed and must be ordered RHR or LHR (see step 4).
3. 6-pin cylinder installation shown.

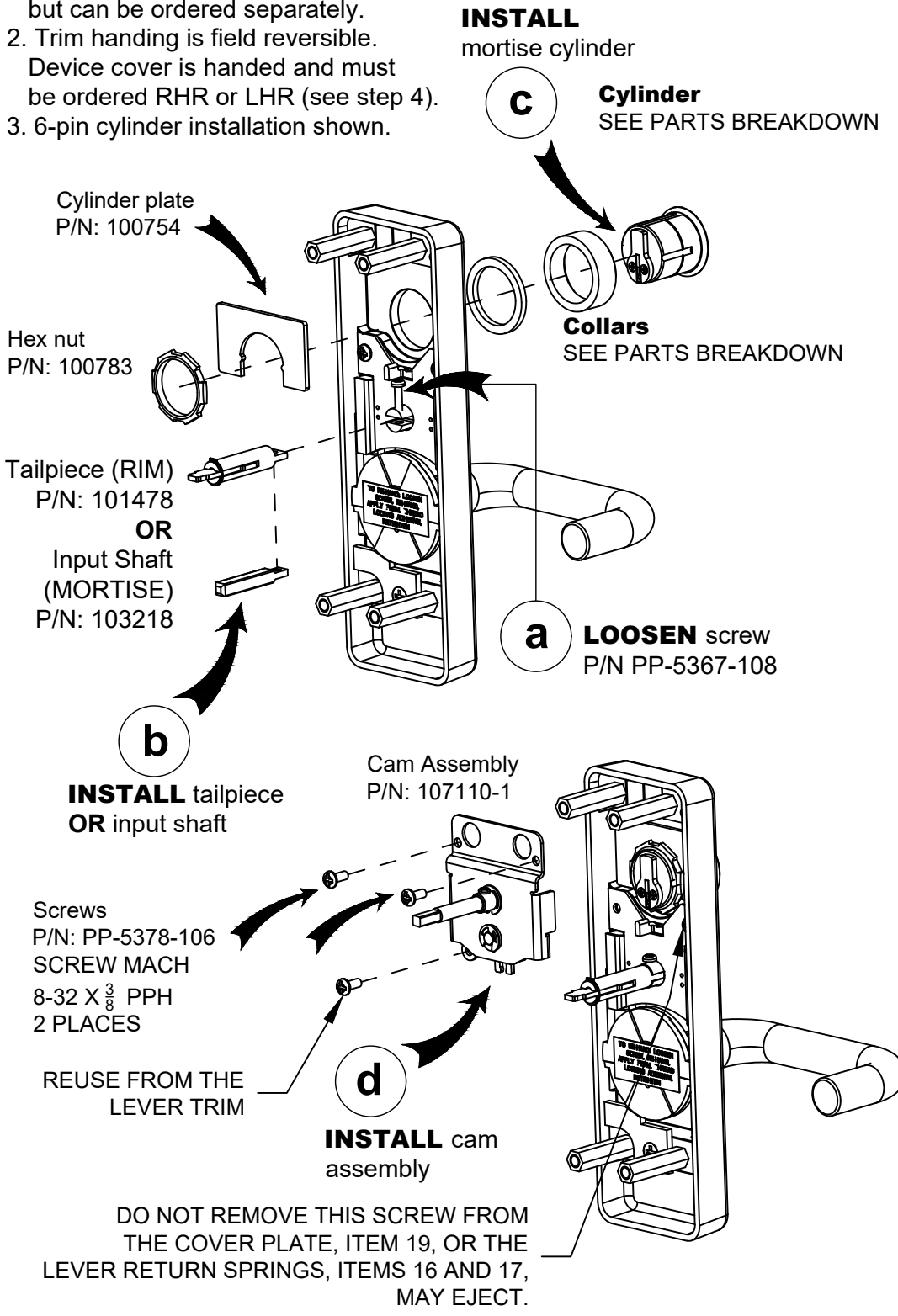

Collar & Spacer Combinations	
	5 pin cylinder (use collar only)
	6 pin cylinder (use collar & 1 spacer)
	7 pin cylinder (use collar & 2 spacers)
	7 pin IC cylinder (use collar & 3 spacers)
Collar & Spacer	

STEP 2: PREP DOOR (Rim)

Mark and drill holes

(LHR installation shown, reverse all steps for RHR)

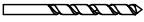
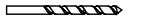
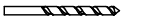
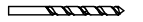
(Metal Doors Only)			
Hole "A"	Hole "B"	Hole "C"	Hole "D"
DRILL 5/16 hole through Device Side	DRILL 1/2 hole through Trim Side	DRILL 3/4 hole through Trim & Device Side	DRILL 1/4 hole through Device Side
			
5/16"	1/2"	3/4"	1/4"

MARK HOLES

DRILL HOLES

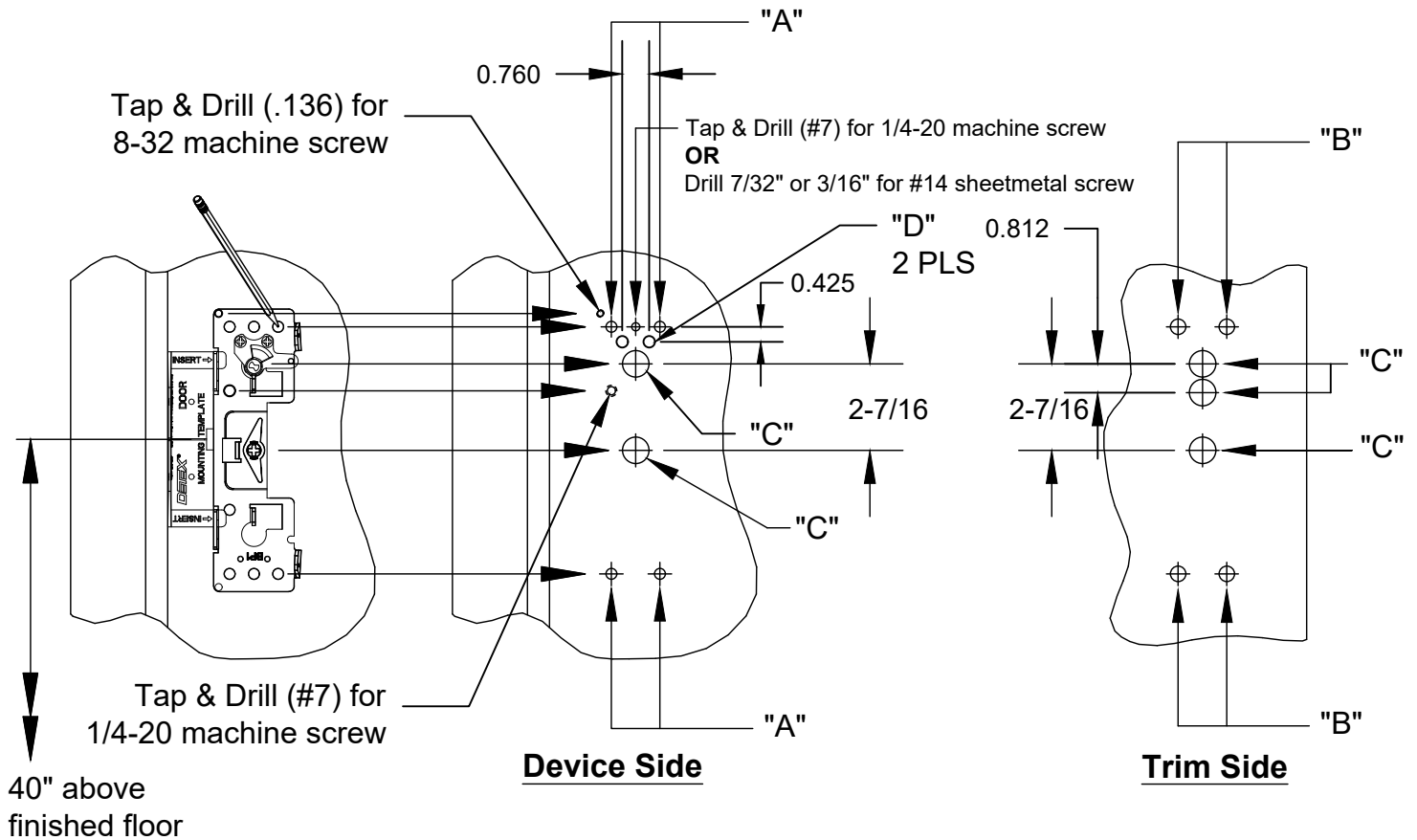

STEP 3: INSTALL TRIM (RIM installation shown)

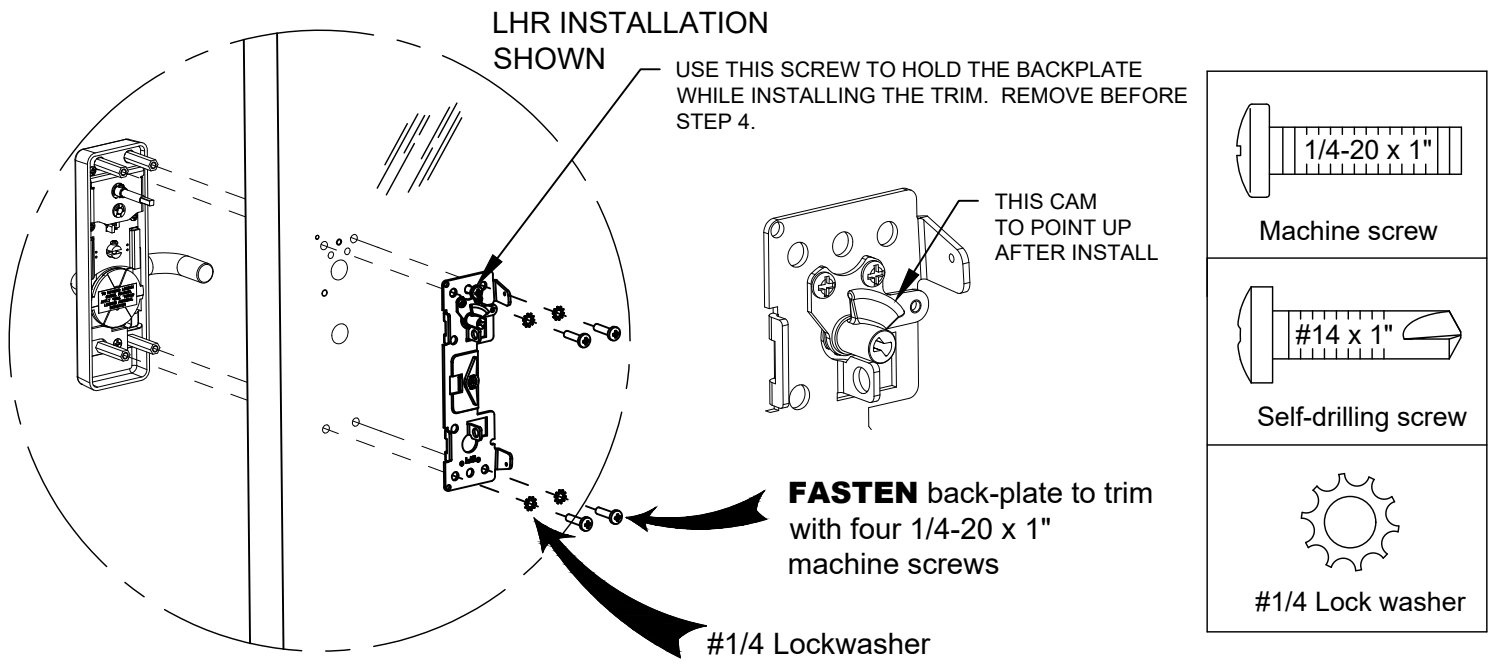

STEP 4: CUT RIM KEY CYLINDER TAILPIECE

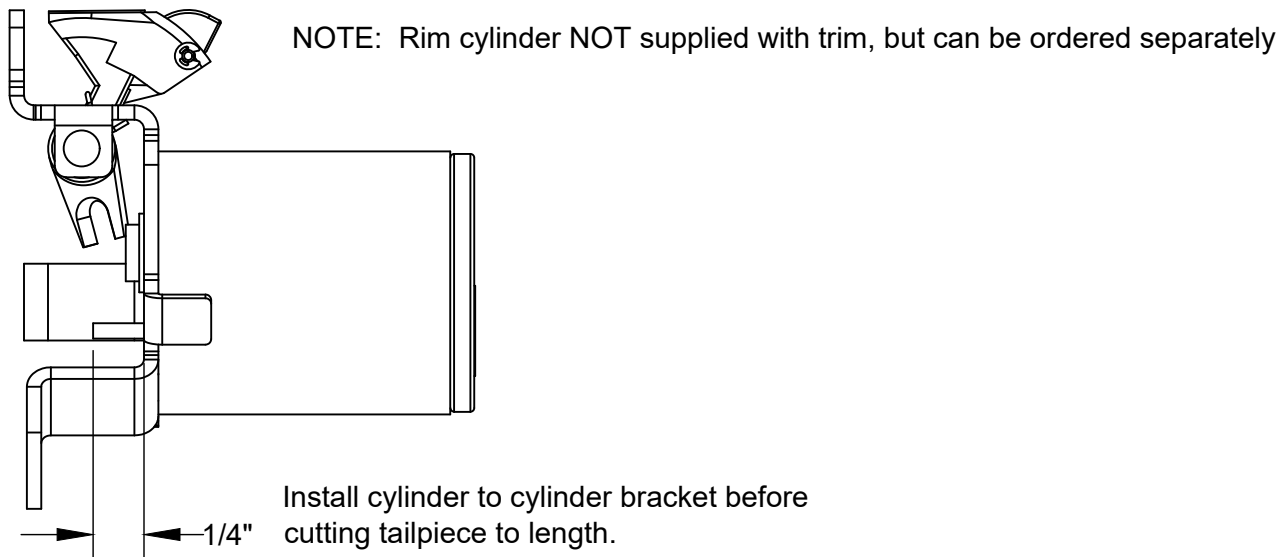

STEP 5: INSTALL RIM CYLINDER TO BRACKET

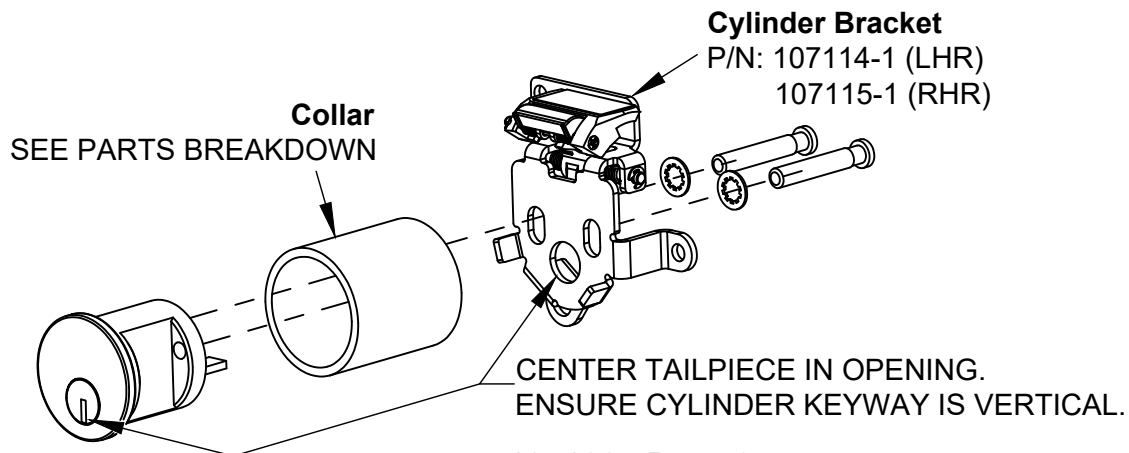

STEP 6: INSTALL ASSEMBLY TO DEVICE BACKPLATE

INSTALL CYLINDER BRACKET ASSEMBLY TO BACKPLATE AND TRIM WITH MACHINE SCREWS SHOWN **AFTER** INSTALLING DEVICE ONTO DOOR.

VARIOUS PARTS NOT SHOWN FOR CLARITY

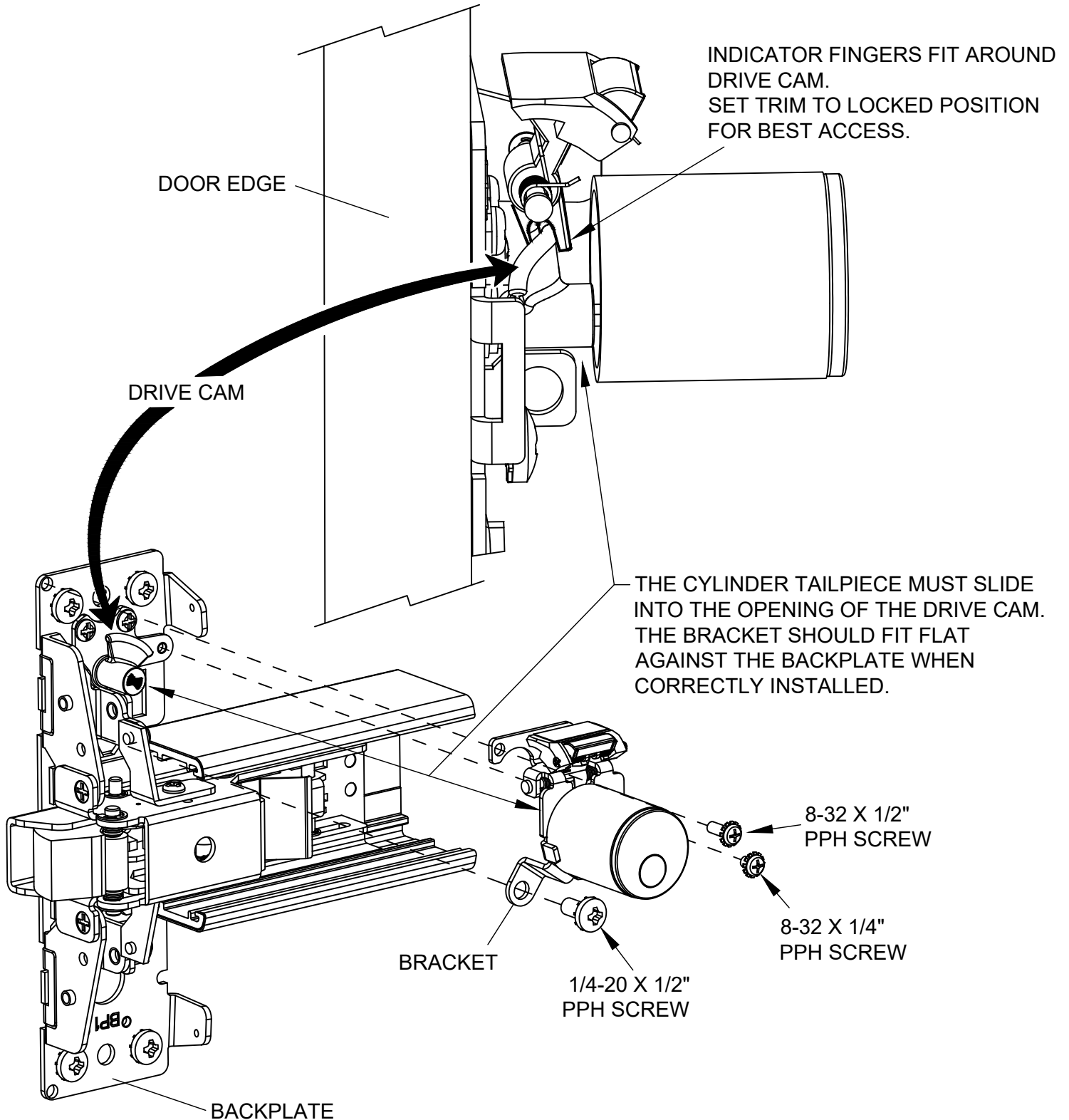

STEP 7: INSTALL COVER

****VERY IMPORTANT****

THE RED INDICATOR **MUST** BE IN THE **UP** POSITION AND FIT INTO THE WINDOW OPENING ON THE COVER AS THE COVER IS PLACED AND ATTACHED. NOT DOING THIS COULD RESULT IN BENDING THE RED INDICATOR PIN AND CAUSE IT TO LOSE FREE MOVEMENT. THIS POSITION IS WITH THE TRIM **LOCKED**.

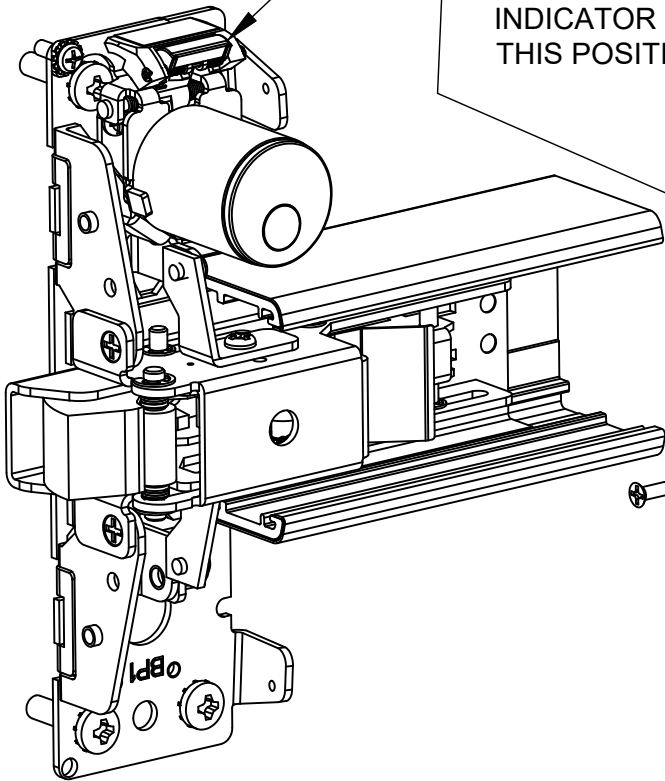

LHR RIM INSTALLATION SHOWN

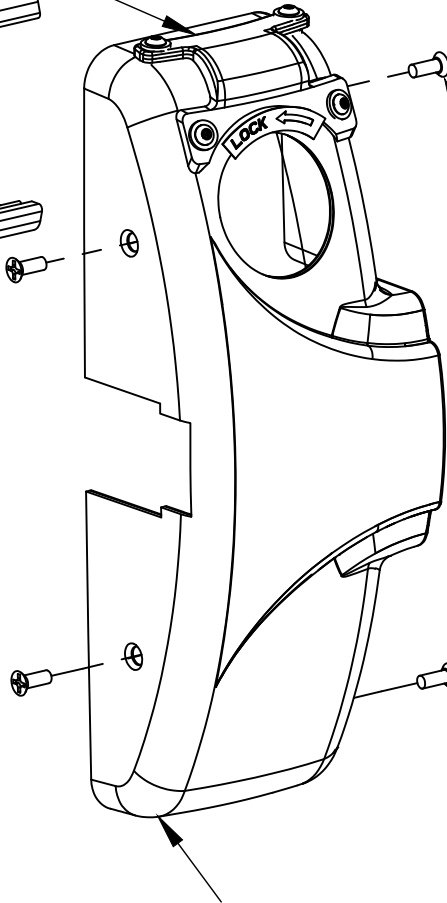

Cover

107116-9 Brushed SS 630, LHR, RIM
107117-18 Brushed SS 630, RHR, RIM

107126-9 Brushed SS 630, LHR, Mortise
107127-18 Brushed SS 630, RHR, Mortise

RECOMMEND THE INSIDE SCREWS BE INSTALLED FIRST LOOSELY THEN OUTSIDE LOOSELY AND THEN TIGHTEN INSIDE FIRST.

TRIM INSTALLATION COMPLETE
Continue installation using device instructions:
101256/101317 for Rim OR 101349 for Mortise.